

### 1 Uninstall Mark

Remove Mark 2 from mount. Remove the device by loosening the mounting screw and carefully lifting the device off the mounting pole.

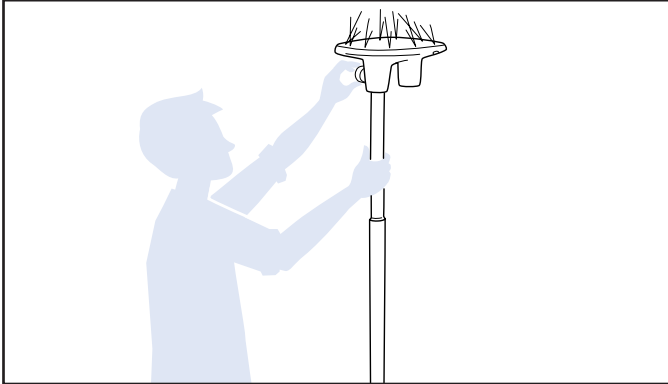

### 2 Undeploy Mark

To undeploy, press and hold the top button for 5 seconds. The top four LEDs will begin blinking blue and then turn off one-by-one in a counter-clockwise direction.

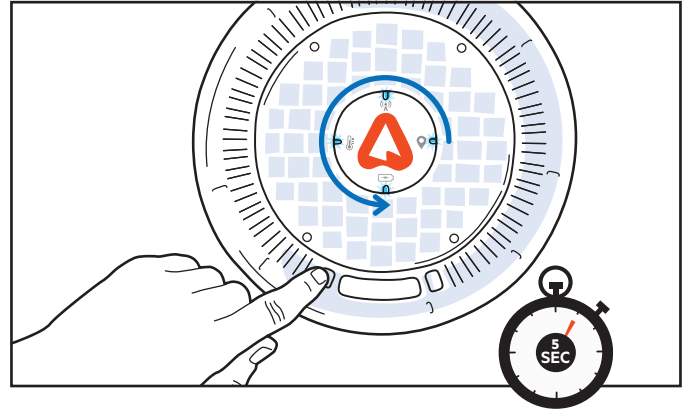

### 3 Confirm Undeployment

Verify by pressing the top button for 1 second, then check the LED on the bottom of the Mark. If yellow, the device has successfully undeployed.

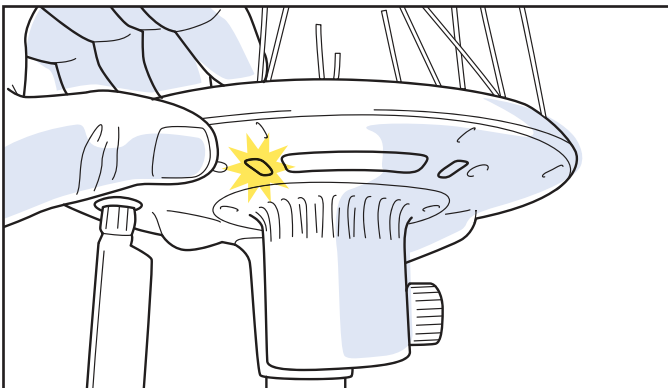

### 4 Uninstall Mounting Equipment

Remove pole and ground anchor, if using. Don't forget a metal rod to unscrew the anchor. Make sure to hold on to the eye bolts.

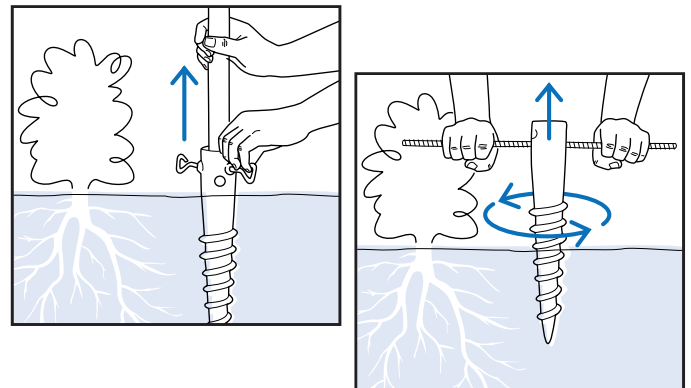

### 5 Remove Bird Spikes

Remove bird-deterrent spikes. Pinch the ends of each spike, and push back through the slots. It may be helpful to have a small pair of pliers nearby.

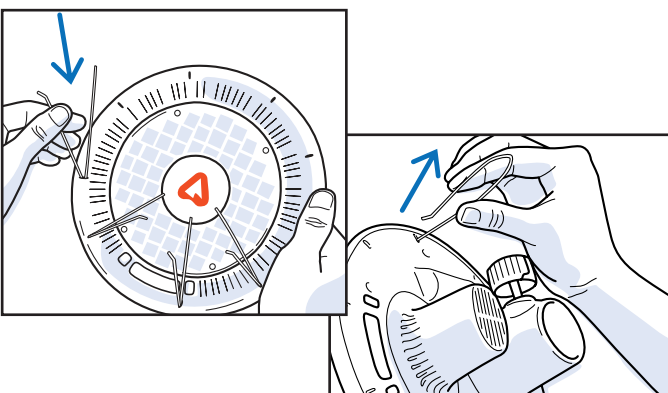

### 6 Wipe Clean

Clean the exterior of the device with a soft cloth. Take special care with the clear dome and the white area over the spectrometer and radiometers.

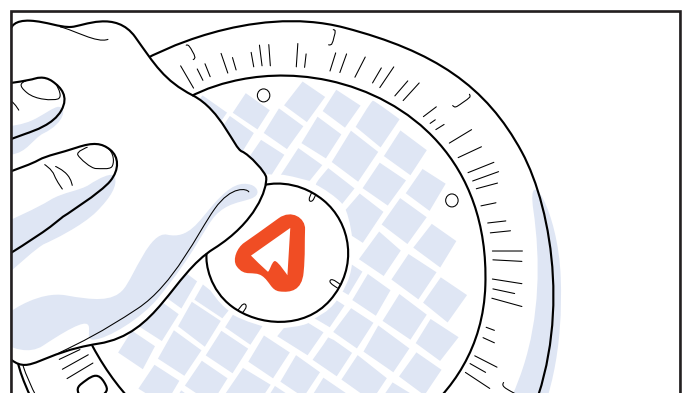

## 7 Store Mark

Store your Mark in a safe location. Store the device and mounting equipment in a dry location that is free of excessive dust. If your Mark has a bendable antenna, make sure it is folded in.

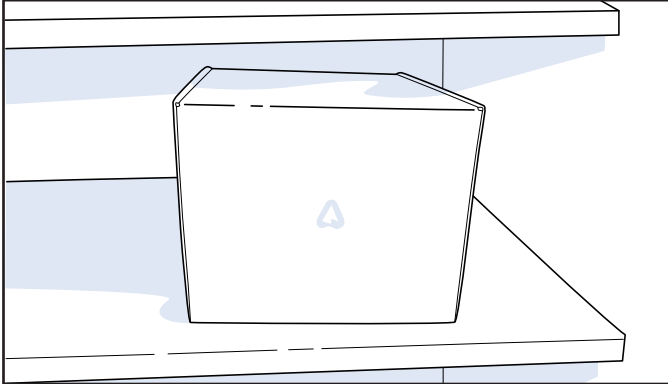

## 8 Check Device Status

The undeployed device should now be in a 'Dormant' state (found on 'Devices' page). Also consider removing any now-outdated teams & users!

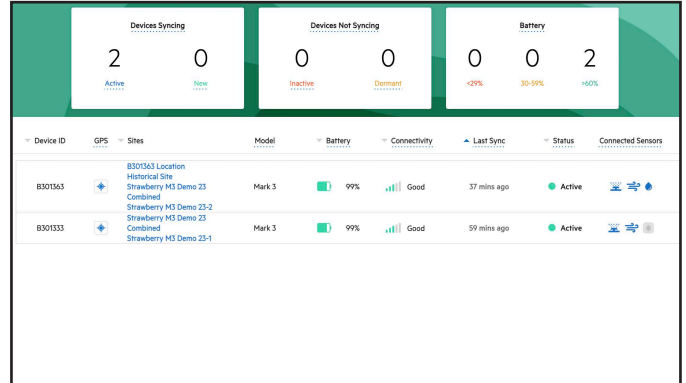

## 9 Export Data

If preferred, download your data. Use our 'Export' feature to save a copy of the hourly and daily data (including exact GPS coordinates) for each now-undeployed location.

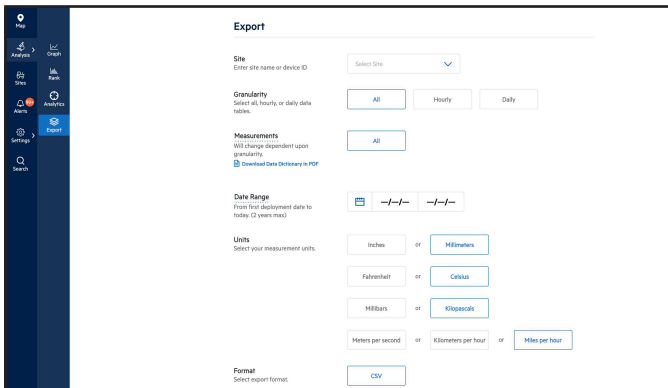

## 10 Contact Us

Let us know about your recent undeployment (and planned reinstallation dates!) so we can assist with any analyses and upcoming installations. Email us at [support@arable.com](mailto:support@arable.com).

